

AZZA

AZZA *TAURUS 5000*

User Manual



www.azzatek.com

Installation Instructions

1. Specifications
2. Chassis parts
3. Control panel functions
4. ODD installation
5. PSU installation
6. 3.5" HDD installation
7. SSD installation
8. 80-90mm installation fan
9. 300mm VGA card and HDD bay installation
10. Clean dust filters
11. install fans in the HDD rack
12. water cooling installation(240/360mm)

Specifications



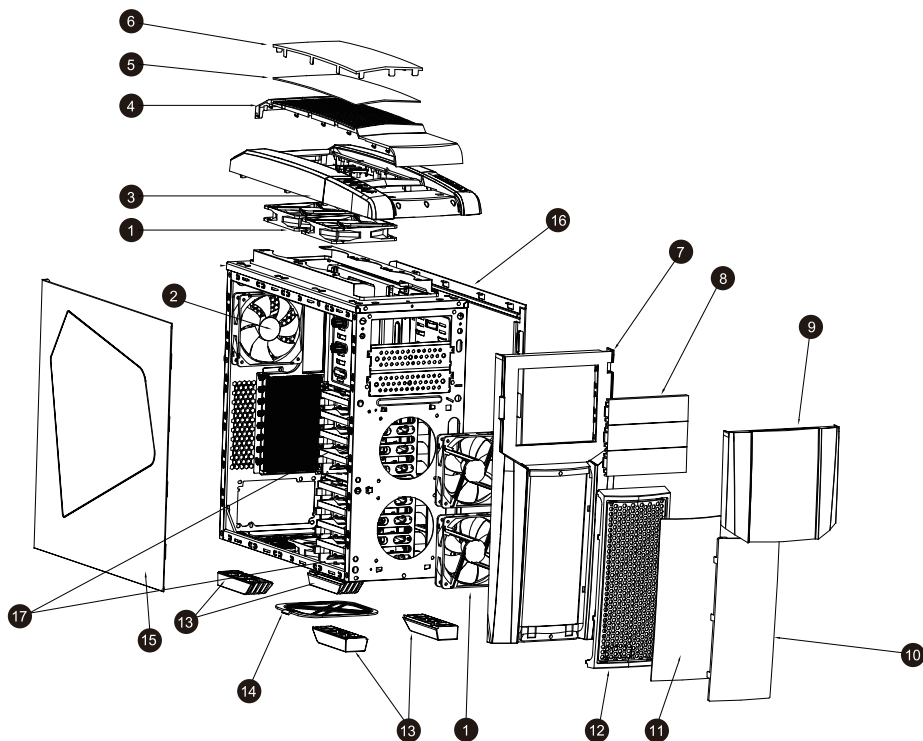

Model:	
Model Name:	TAURUS 5000
Model Number:	CSAZ-5000B/CSAZ-5000W
Spec:	
Type:	ATX Full Tower
Color:	Black/Black(inside chassis)/White/Black(inside chassis)
Side Panel Window:	Yes, with RGB LED color
With Power Supply:	No
CPU Cooler Compatibility:	up to 180mm
Motherboard Compatibility:	Full ATX, Micro ATX
Power Location	Rear Bottom
Expansion:	
External 5.25" Drive Bays:	3
Internal 3.5" Drive Bays:	8
Internal 2.5" Drive Bays:	8
Expansion Slots:	8
Front Ports:	2x USB 3.0, 2xUSB 2.0, Audio
Cooling System:	
120mm Fan:	2x120mm LED Fan on The Top
120mm Fan:	2x120mm LED Fan in the front
120mm Fan:	1x120mm Fan in Rear
Physical Spec:	
Dimensions(HxWxD)	21"x8.3"x20.6"(533mmx210mmx523mm)
Weight	10.2Kg(22.5 lbs)
Features:	
Modularized HDD cage design	Removable HDD cage allows you to install the longest VGA card
Exceptional Cooling System Total 5 fans	2x120mm fan located on top, exhausts the hot air out 2x120mm fan located in the front, takes in the cool air 1x120mm fan located in the rear, exhausts the hot air out
RGB LED color for side panel	Provides RGB multiple LED color for side window.
Maximum Capacity Water Cooler	Supports 1x240mm and 1x120mm water cooling system
Supports longest VGA card	Accommodates VGA card up to 400mm
Screw-less design	Screw-less design for ODD and HDD
Easy install CPU cooler	A hole for easy install CPU cooler, no need to remove motherboard.

Chassis parts





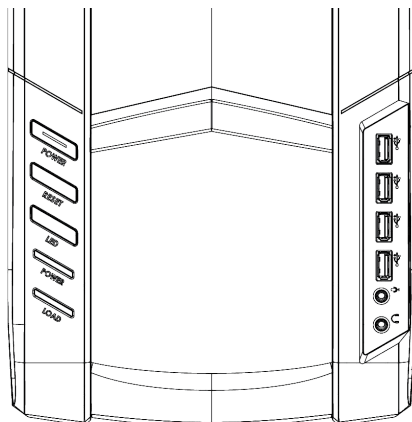

1	4X120mm LED fan (included)
2	120mm rear fan (black)
3	Top cover
4	Top Grid
5	Top filter
6	Top metal mesh
7	Front bezel
8	5.25" Device Cover X3
9	Door
10	Front metal mesh
11	Front filter
12	Front grid
13	Stand X4
14	Bottom dust filter
15	Left side panel
16	Right side panel
17	HDD rack x2

Control panel functions

	Power
	Reset
	Power Led
	Power Indicator
	HDD Indicator



	USB3.0(Blue)
	USB2.0(Black)
	Mic
	Audio

ODD installation

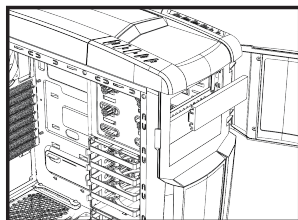

Take out drive cover.

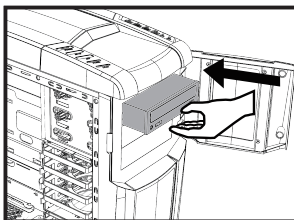

Inser ODD drive.

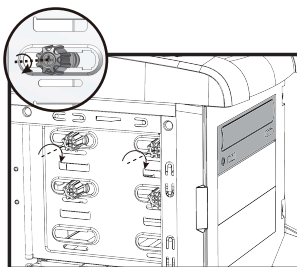

Fix ODD drive.

PSU installation

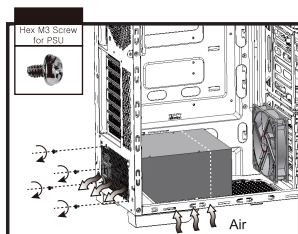

Fix PSU.

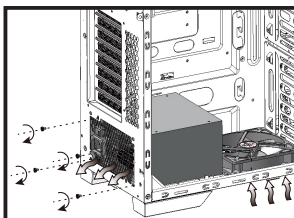

Insert PSU.

3.5" HDD installation

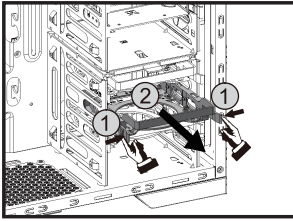

Remove the bay bracket.

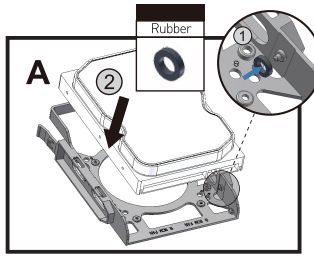

No need for screws.

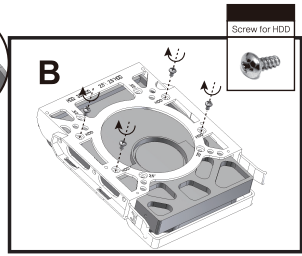

Fix with screw.

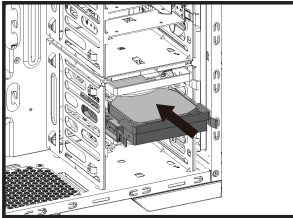

Insert the hard drive into place.

2.5" SSD installation

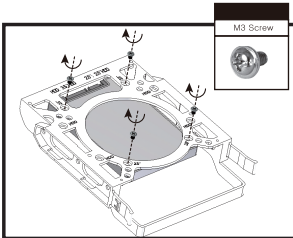

Fix with screws.

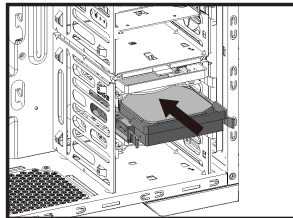

Insert the hard drive into place.

80-90mm fan installation

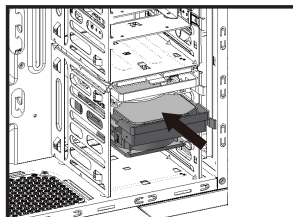
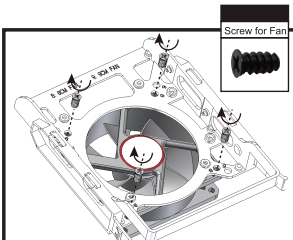

when installing fan over hard disk, you can only use 7 drive bays.

300mm VGA card and HDD bay installation

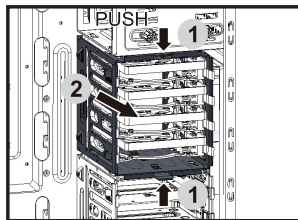

Remove the HDD rack.

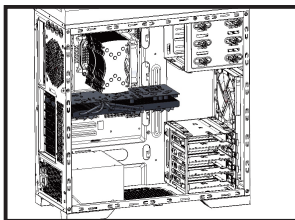

Install VGA card.

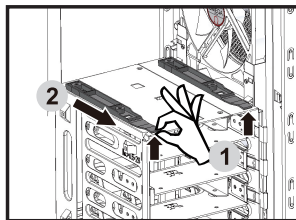

Remove the hard drive rails.

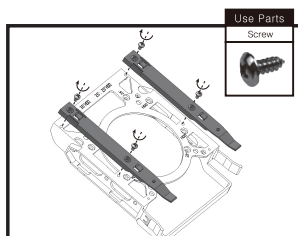

Fix with screws.

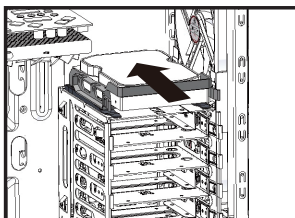

Place the hard drive in place.

Clean dust filters

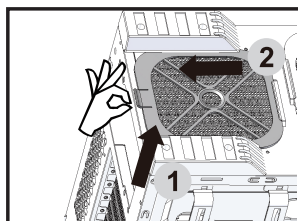

Remove the dust filter from the PSU position.

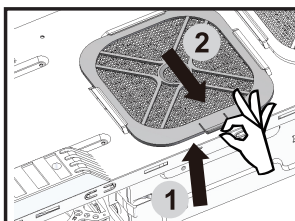

Remove the dust filter from the PSU bottom.

install fans in the HDD rack

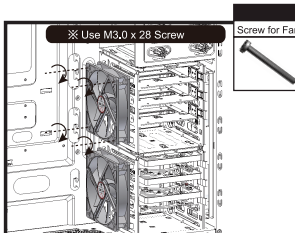
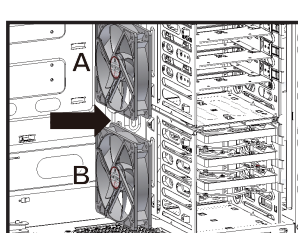

If installing fan on the bottom, can't install fan for position B.

water cooling installation(240/360mm)

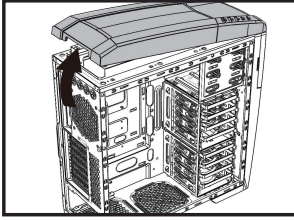

Remove screws from top panel.

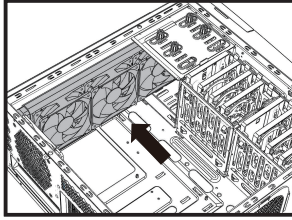

put the radiator in its place.

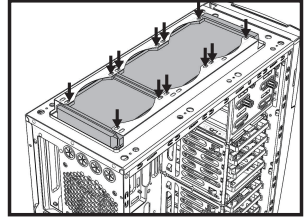

Fix with screws.

Caution

1. Please read and understand the contents of this user manual prior to installation.
2. Check all components before installation, if any problem is found, contact with the retailer to obtain a replacement.
3. Refrain from touching any moving parts to prevent injuries.
4. Please refer to the manual for cable/installation. Incorrect installation can lead to short-circuiting and/or damages.
5. Do not block the front and rear air vents.
6. Do not clean any surface with chemical cleaners or solvents.
7. Wear gloves during the installation process to prevent injuries.
8. The specifications may change without prior notice.

